

- For operation of air control dampers in HVAC system
- Torque: 4Nm
- Nominal voltage: AC/DC 24V
- Control: Open/Close (not made for 3-point applications)



Technical data

Electrical data	Nominal voltage	AC 24V 50/60Hz, DC 24V	
	Nominal voltage range	AC 19.2...28.8V / DC 21.6...28.8V	
	Power consumption	13W @ nominal torque / 1.5W @ holding	
	For transformer sizing	23VA (Imax. 20A @ 5ms)	
	Connecting cable	Cable 1m, 3x0.75mm ²	
Functional data	Torque	4Nm @ nominal voltage	
	Direction of rotation	Reversible with switch 0 ↺ or 1 ↻	
	Manual override	Gearing latch disengaged by push button, self-resetting	
	Angle of rotation	Max. 95°, adjustable by mechanical stops	
	Running time	2.5s	
	Automatic adjustment of operating range to match the mechanical angle of rotation	Manual triggering of the adaption by pressing the «Adaption» button	
	Sound power level	Max. 52dB(A)	
	Position indicator	Mechanical, remote visible	
	Negative torque	⚠ ≤ 50% from nominal torque (with restrictions)	
	Working conditions	Protection class	III (safety extra-low voltage)
Degree of protection		IP54	
EMC		CE according to 2004/108/EC	
Mode of operation		Type 1 (EN 60730-1)	
Ambient temp.		-30...+40°C (without restrictions) ⚠ +40...+50°C (with restrictions)	
Non-operation temp.		-40...+80°C	
Humidity		5...95% RH, non-condensing	
Maintenance		Maintenance-free	
Dimensions / weight		Dimensions (LxWxH)	See "Dimensions"
		Weight	0.85kg

Dimensions [mm]

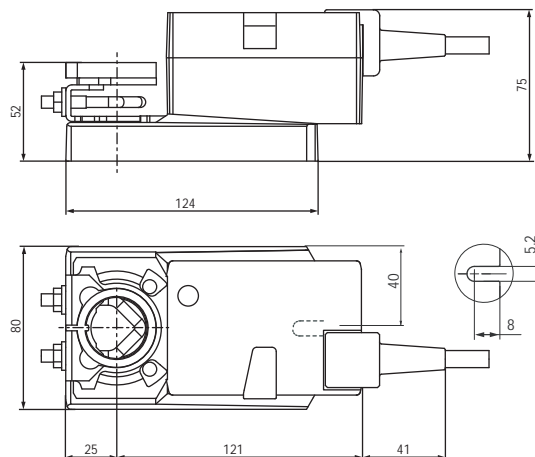

Damper spindle	Length	● I	■ I	◆ I
	≥40	8...26.7	≥8	≤26.7
	≥20	8...20	≥8	≤20

* Option (accessory K-NA)

- For operation of air control dampers in HVAC system
- Torque: 4Nm
- Nominal voltage: AC/DC 24V
- Control signal: DC (0)2...10V
- Position feedback: DC 2...10V



Technical data

Electrical data	Nominal voltage	AC 24V 50/60Hz, DC 24V	
	Nominal voltage range	AC 19.2...28.8V / DC 21.6...28.8V	
	Power consumption	13W @ nominal torque / 1.5W @ holding	
	For transformer sizing	23VA (Imax. 20A @ 5ms)	
	Connecting cable	Cable 1m, 4x0.75mm ²	
	Functional data	Torque	4Nm @ nominal voltage
		Control signal Y	DC (0)2...10V @ input impedance 100kΩ
		Position feedback signal U	DC 2...10V @ max. 0.5mA
		Position accuracy	±5%
		Direction of rotation	Reversible with switch 0 or 1
Direction of motion at Y=0V		At switch position 0 ↺ resp. 1 ↻	
Manual override		Gearing latch disengaged by push button, self-resetting	
Angle of rotation		Max. 95°, adjustable by mechanical stops	
Running time		2.5s	
Automatic adjustment of operating range and measuring signal U to match the mechanical angle of rotation		Manual triggering of the adaption by pressing the «Adaption» button	
Working conditions	Sound power level	Max. 52dB(A)	
	Position indicator	Mechanical, remote visible	
	Negative torque	⚠ ≤ 50% from nominal torque (with restrictions)	
	Protection class	III (safety extra-low voltage)	
	Degree of protection	IP54	
	EMC	CE according to 2004/108/EC	
	Mode of operation	Type 1 (EN 60730-1)	
	Ambient temp.	-30...+40°C (without restrictions) ⚠ +40...+50°C (with restrictions)	
	Non-operation temp.	-40...+80°C	
	Humidity	5...95% RH, non-condensing	
Dimensions / weight	Maintenance	Maintenance-free	
	Dimensions (LxWxH)	See "Dimensions"	
	Weight	0.85kg	

Dimensions [mm]

Damper spindle	Length	● I	■ I	◆ I
	≥40	8...26.7	≥8	≤26.7
*	≥20	8...20	≥8	≤20

* Option (accessory K-NA)

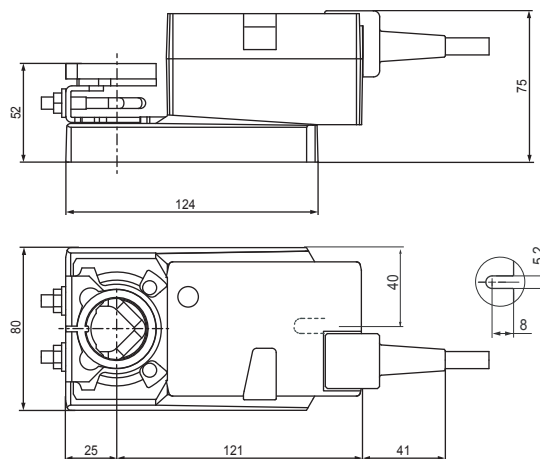

Wiring diagrams: Open/Close actuators—parallel connection possible, please note the performance data.

1-wire control

AC 24V
 DC 24V

Direction of rotation (while direction of rotation reverses)

**LMU24-S, NMU24-S
SMU24-S**

**LMU24(-T/-F), NMU24(-T), SMU24
GMU24, LMQU24, NMQU24, SMQU24**

AC 100...240V

**LMU230-S, NMU230-S
SMU230-S**

**LMU230(-F), NMU230
SMU230(-F), SMDU230, GMU230**

2-wire control

AC 24V
 DC 24V

Direction of rotation (while direction of rotation reverses)

**LMU24-S, NMU24-S
SMU24-S**

**LMU24(-T/-F), NMU24(-T)
SMU24, GMU24***

AC 100...240V

**LMU230-S, NMU230-S
SMU230-S**

**LMU230(-F), NMU230(-F)
SMU230(-F), SMDU230, GMU230***

*GMU.. only for Open/Close application.

Wiring diagram: Modulating actuators—parallel connection possible, please note the performance data.

AC 24V
 DC 24V

Y ← DC (0)2...10V
 U → DC 2...10V

**LM(Q)U24-SR, NM(Q)U24-SR
SM(Q)U24-SR, GMU24-SR**

AC 100...240V

AC 24V power output

Y ← DC (0)2...10V
 U → DC 2...10V

**LMU230SR, NMU230SR
SMU230SR**

Position - signal voltage

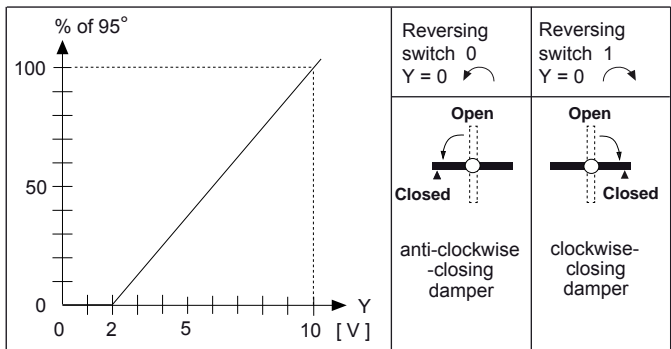

Direction of rotation